

***HYDRUALIC MOTORS AVAILABLE:**

PART #	DISPLACEMENT	RATED PSI
4900 - 16	.31 cu. in.	3,000
4900 - 15	.29 cu. in.	3,000

INERSPACE CORP.
 1138 E. EDNA PLACE
 COVINA, CA 91724
 TEL: (626) 331-0921
 FAX: (626) 966-6391
 www.innerspacethrusters.com

13- Spacers are not shown.
 If needed, the spacers will go
 between the hub & prop to
 achieve a prop tip clearance
 of .010" - .020"

ITEM #	QTY	PART NAME	PART NO.
17	1	HYDRAULIC MOTOR	4900*
16	2	TAB - MOTOR FAIRING	1001 - W
15	1	MOTOR FAIRING	1001 - V
14	1	DUCT	1001 - O
13	1	SPACER - .063" OR .125"	1001 - M
12	1	WASHER - PROP HUB	1001 - L
11	1	NUT - SHAFT	1001 - K
10	4	SHCS - MOTOR	1001 - I
9	1	KEY	1001 - H
8	1	HEX NUT - TIE ROD	1001 - G
7	1	NYLOX NUT - TIE ROD	1001 - J
6	1	SPINNER	1001 - F
5	1	TIE ROD	1001 - E
4	1	WASHER - SPINNER	1001 - D
3	4	SHCS - PROP HUB	1001 - Q
2	1	PROPELLER HUB	1001 - C
1	1	3 BLADE PROPELLER	1001 - A

PARTS LIST

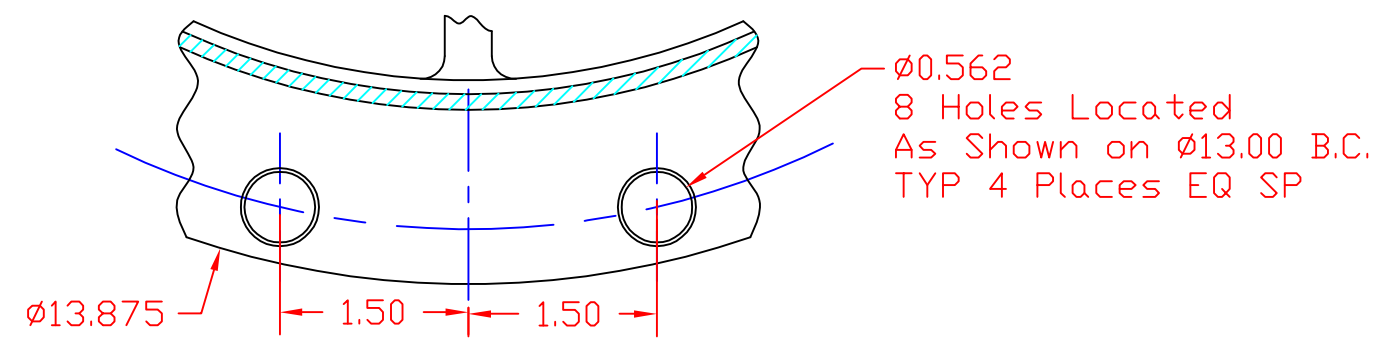

Section A - A

PROPRIETARY

TOLERANCES (EXCEPT AS NOTED)		REVISIONS			INERSPACE CORP.		
	NO.	DATE	BY				
.XXX	1						
± .005	2						
.XX	3						
± .01	4						
ANGULAR	5						
± 1/2							

1001/4900 HYDRAULIC THRUSTER ASSEMBLY

DRAWN BY OR SCALE DATE 08/12/09 MATERIAL
 CHECKED DATE 08/12/09 DRAWING NO.
 TRACED APPROVED 1001/4900 - ASSY